



# CURRIE TECHNOLOGIES

Hybrid Electric Bicycles & Scooters

CURRIE TECHNOLOGIES®  
 9453 Owensmouth Ave., Chatsworth, CA 91311 USA  
 Phone: +1 800 377 4532 | Fax: +1 818 734 8199  
 currietech.com | izipusa.com | ezipusa.com  
 sales@currietech.com | sales@izipusa.com



## PnP battery pack for use with Currie Technologies® electric scooters

All batteries come in a quick change PnP (Plug and Play) battery pack for on-board or off-board recharging. SLA (Non-Spillable Sealed Lead Acid) battery pack last over 200 recharge cycles. Charger not included.

- **Part # AC-BAT1-PK** (24V10A SLA PnP Battery Pack) for use with iZip or eZip 400 and 500 series scooter
  - Initial Charge Time is 8 hours
  - Recharge Time is 6-8 hours
  - Do not charge longer than 24 hours
- **Part # BA-PK24-002A** (24V12A SLA PnP Battery Pack) for use with iZip or eZip 750 and 900 series scooter
  - Initial Charge Time is 10 hours
  - Recharge Time is 8-10 hours
  - Do not charge longer than 24 hours
- **Part # AC-BAT2-PK** (36V10A SLA PnP Battery Pack) for use with eZip 1000 series scooter
  - Initial Charge Time is 8 hours
  - Recharge Time is 6-8 hours
  - Do not charge longer than 24 hours
- **Part # BA-PK36-001** (36V12A SLA PnP Battery Pack) for use with iZip 1000 series scooter
  - Initial Charge Time is 10 hours
  - Recharge Time is 8-10 hours
  - Do not charge longer than 24 hours

## ! WARNING

- Read the instructions
- Use of the wrong type of charger could cause a fire and/or explosion resulting in serious injury or death
- To prevent electric shock, do not immerse in water
- Use the charger in dry location only
- Use only Currie Technologies approved 24V SLA charger with 24V10A or 24V12A SLA PnP battery pack
- Use only Currie Technologies approved 36V SLA charger with 36V10A or 36V12A SLA PnP battery pack
- This product is not intended for children; it is for adult use only. Charger is not a toy.
- Due to risk of injury never allow children to charge the battery. Battery charging must be done by adults only.
- Due to risk of injury never allow children to handle the battery pack. Battery pack is to be handled by adults only. The battery pack is heavy and contains sulfuric acid (electrolyte). Dropping the battery pack could result in injury.
- In order to prevent fire never modify the electrical system. Alterations could cause fire or explosion resulting in serious injury or death
- Always use the handle of the battery pack to lift or carry the battery pack. Never lift or carry the battery pack by the wires or connector as this may damage the battery pack and possibly cause a fire or explosion.
- The battery pack, charger and charger port should be regularly inspected for damage or excessive wear (cord, plug, enclosure, etc.). If damage or excessive wear is found stop using until item(s) can be repaired or replaced.

## ! ATTENTION

- Be sure to charge battery pack at least every 30 days even if not used. Doing so will help to maximize the life of your battery pack
- Do not store batteries below 50° Fahrenheit and never allow batteries to freeze (below 32° Fahrenheit).
- Always be sure to turn the scooter "OFF" after each use via the On/Off power switch.

## CHARGING THE BATTERY PACK OFF-BOARD (i.e. not installed in scooter)

Use only a Currie Authorized Smart Charger to charge the batteries. Using any other charger may damage the batteries and void your warranty. The charger unit has lights that show the battery charge status. Refer to the instructions that appear on the charger unit.

1. Attach the off-board charger adaptor to the battery pack. Be sure to fully insert the connectors into each other.
2. Attach the charger to the off-board charger adaptor
3. Plug the Battery Charger's AC plug into a standard, grounded 110V AC wall outlet. If the power to the outlet is controlled by a switch be sure the switch is "ON".
4. Let the batteries charge until the charger lights indicate that the batteries are fully charged, then unplug the charger from the scooter and the wall outlet.

Always store SLA (Sealed Lead Acid) batteries with a full charge. Fully recharge after each and every ride. If you leave the batteries in a run-down condition it will shorten their life expectancy. The charger may get warm to the touch, so make sure you charge them in an open area and do not lay anything on the charger unit while charging. Although you cannot over-charge the batteries using the Currie "Smart Charger", we recommend that you do not leave the charger plugged in for more than 24 hours.

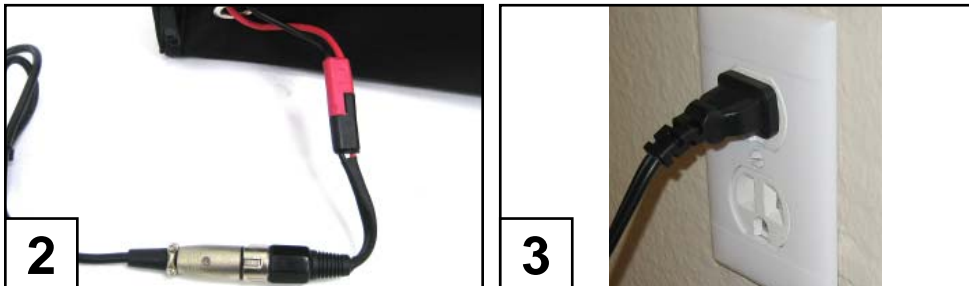
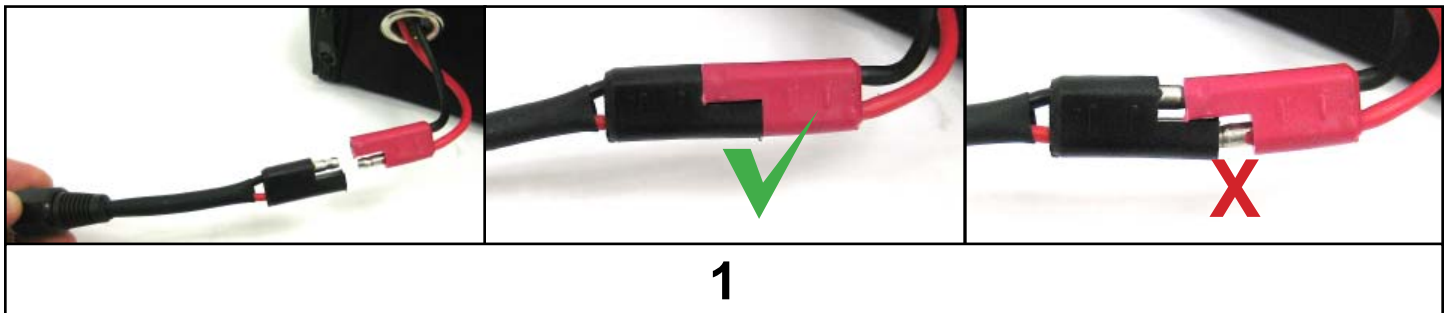

## REPLACING THE BATTERY PACK

1. Turn the power switch "OFF"
2. Remove the platform by unscrewing the bolt located under the on/off switch.
3. Disconnect the battery pack
4. Remove the battery pack.
5. To install a new battery pack repeat steps 1-4 in reverse order.



## BATTERY CARE

In the unlikely event that you suspect fluid is leaking from your battery follow the precautions below.

**Internal exposure:** If battery acid is ingested give water, milk of magnesia or egg whites immediately. Never give emetics or induce vomiting. Contact a physician immediately.

**External exposure:** If battery acid comes in contact with skin or eyes flush immediately with cool water for 15 minutes. Contact a physician immediately

If the battery develops a leak avoid contact with the fluid (battery acid). Place leaking battery into a plastic bag and dispose of safely and properly.

- Charge the battery pack for the recommend initial charge time
- Never charge the battery pack for more than 24 hours
- Do not allow battery to completely discharge before recharging
- Storing the battery in a partially discharged state will greatly reduce its life expectancy
- Recharge after each use regardless of time used
- Fully charge battery before storing
- Be sure to charge battery pack at least once every 30 days even if not used. Doing so will help to maximize the life of your battery pack
- Do not store batteries below 50° Fahrenheit or above 80° Fahrenheit in order to help maximize the battery life
- Never allow batteries to freeze. Freezing temperature depends on charge state of the battery, so store at full charge, to avoid damage. Battery capacity is greatly reduced by low temperatures because the electrolyte thickens and is less active. In order to perform satisfactorily in cold weather the battery must be kept in peak condition, so when the temperature drops you will have to keep a closer watch on the battery.
- Never allow batteries to be stored or operated in excessively hot temperatures. The optimum operating temperature is 77° Fahrenheit for most VRSLA (Valve Regulated Sealed Lead Acid Battery). Storing or operating the battery in excessively hot temperatures (+90° Fahrenheit) will greatly reduce the available capacity.
- Always be sure to turn the scooter "OFF" after each use via the On/Off power switch.
- Do not store battery on surfaces that could be damaged if the battery were to leak battery acid. Take precautions to protect the surface on which you store the battery.

## BATTERY DISPOSAL

Please join us in our commitment to improve the environment by recycling your old batteries.

- The PnP battery pack consists of two (for 24V pack) or three (for 36V pack) 12V non-spillable sealed lead acid batteries. They must be recycled or disposed of in an environmentally safe and legal manner.
- The batteries used in the PnP battery packs are chemically identical to common automotive starter batteries and can be returned to any site that accepts automotive lead acid batteries for recycling. Examples include automotive service stores, automotive service centers, battery recyclers, etc. To find a battery recycling facility in your area please visit either of these websites:
  - [www.earth911.com](http://www.earth911.com)
  - [www.thinkgreen.com/recycle-where.com](http://www.thinkgreen.com/recycle-where.com)
- When recycling lead batteries do not mix them with non-lead batteries. Non-lead batteries pose a fire/explosion hazard if brought to a lead battery recycling facilities. Lead batteries (example: sealed lead acid batteries, etc.) and non-lead batteries (example: lithium ion, nickel metal hydride, etc.) are recycled at different facilities.
- Do not dispose of batteries in a fire due to risk of explosion
- Do not dispose of these batteries in your regular household trash. The incineration and/or disposal in a landfill is prohibited by law in most countries, including the USA.
- In the event of disposal, dispose only in accordance with federal, state and local regulations.
- Protect the environment by not disposing of this product with household waste (Directive 2002/96/EC). Check your local authority for recycling advice and facilities (Europe only).

