



Included in your parts box:

- Toolkit (4+5mm combo hex wrench, 13+15mm combo open-end wrench)
- Touch-up paint
- Reflectors (if not already installed)

Required Tools (not included):

- Scissors or wire cutters
- 10mm open-end wrench (may be needed)

Assembly will take about 30 minutes



Electrical System

Your electric scooter comes with a 24 volt sealed lead-acid (SLA) battery. This type of battery does not have a memory, and riding on a partial charge will not affect its capacity or performance (you can safely test ride the scooter after assembly, although it won't be fully charged.). Recommended charge time for this type of battery is 4-6 hours.

Basic Troubleshooting

<p>Scooter won't turn on (no lights on throttle)</p>	<ul style="list-style-type: none"> • 5-minute auto shutoff feature has activated; turn scooter off then on again • Battery not charged • Battery may not be connected from factory. Remove your scooter's deck plate using the thumb screw under the on/off switch, connect the battery, then replace the plate • The scooter's fuse may be blown. See your owner's manual for more information on locating and replacing this fuse, or call our Customer Service line for help
<p>Brakes rub when riding</p>	<ul style="list-style-type: none"> • Re-adjust the brakes, referring to the attached document. Do not ride the scooter if the brake pads are rubbing the front tire.
<p>Can someone help me with...?</p>	<p>Call the Currie Technologies technical and customer service department at 1-800-377-4532</p>

Currie Technologies Technical and Customer Service **1.800.377.4532**

450 QSG V1 2011

Last modified April 27, 2011 4:14 PM



Assembly Guide



Unpacking and Preparation



1. Carefully remove the scooter and all accessories from the box.
2. Lift the scooter onto the box as shown in photo A. This will make all sides of the scooter accessible and easier to work on.

Seat Mast

3. Insert the seat mast into the frame, making sure that it passes completely through the three supporting rings shown in photo B. You may need to twist the mast to work it into the lowest ring.
4. Make sure the seat is facing forward, then tighten the binder bolt shown in photo C using the included hex wrench until the mast can no longer be made to turn.



Steering Column and Handlebars

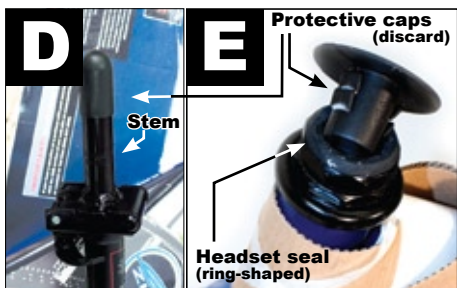

5. Remove the protective caps from the stem and head tube (photo D & E). Be careful not to discard the rubber ring headset seal shown in photo E.

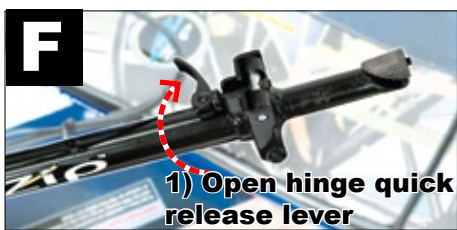

6. Unlock the handlebar post hinge as instructed in photos F, G, & H, then fold the hinge open. The hinge may initially be stiff and difficult to fold, but after a few folds it will loosen and be much easier to use.

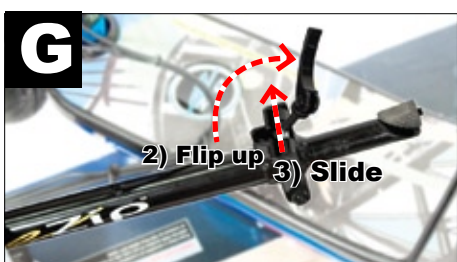

7. Insert the stem completely into the scooter's head tube (past the minimum insertion line marked on the stem). Align the handlebar post to be in-line with the front wheel as shown in photo I, then tighten the stem binder bolt with the provided 13mm open-end wrench. **It is vital to your safety that this bolt is tightened securely! Failure to fully tighten the bolt could cause the wheel to turn away from the handlebars, causing a crash.**

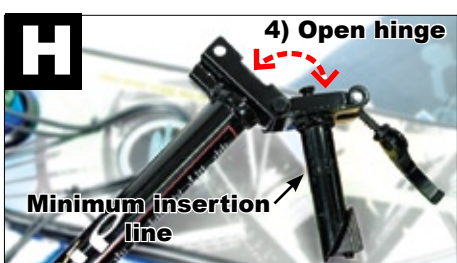

8. Raise the handlebar post, then close the hinge quick release lever by reversing step 6. If the quick-release lever feels loose or is not secure, its preload may need to be adjusted by tightening the 10mm preload-adjustment nut shown in photo I.

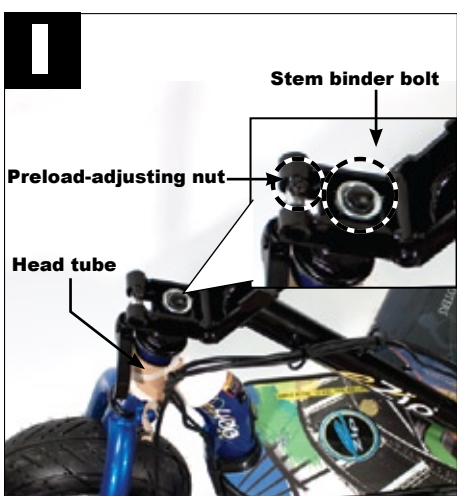

9. Remove the cap bolts and the cap itself from the top of the handlebar post (image J). Hold the handlebar onto the top of the post, then replace the cap and tighten the bolts. Make sure the handlebar and wires are properly aligned, as they are in photo K. The brake lever should be on the left side of the scooter (and the throttle on the right), and there should be no twisting in the wires coming from the handlebar.

The cap is symmetrical; it can be attached in either direction. Be sure you **tighten the cap bolts evenly**, verifying that the gaps on each side of the handlebar are equal as shown in photo L.

10. Remove any remaining packaging material. Place the scooter on the ground and verify that the handlebars are aligned properly with the front wheel. Shake the handlebars to make sure there is no play in the assembly; if the scooter's front end rattles or does not feel secure, you may not have completely tightened the steering column hinge or the wedge bolt. Additionally, **check that the front wheel nuts are securely tightened** using the supplied 15mm open-end wrench.

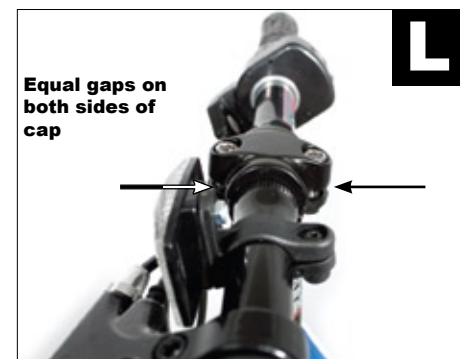
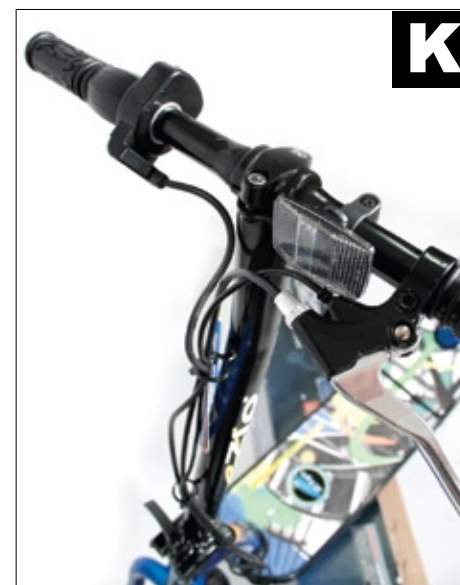

Before your first ride...

